

# FIRE & SMOKE CONTAINMENT CAVITY BARRIERS

(IDEAL FOR CREATING SMOKE RESERVOIRS IN WAREHOUSES)



**Light weight, flexible  
and slimline systems**

## GENERAL

Large warehouses often require smoke reservoirs to ensure efficient operation of smoke and heat vents or smoke spill fans. Traditional methods of creating these reservoirs using sheet steel for example are heavy, cumbersome and it is also difficult to create an effective smoke tight seal around structural or service penetrations.

Hot smoke travelling horizontally along the underside of a warehouse roof may cause excessive smoke damage and activate excess sprinklers creating water damage, significantly hindering a businesses recovery after a fire.

SMOKEHALT FS is a flexible, slimline, lightweight static fire and smoke barrier manufactured from specially treated woven glass fabric. SMOKEHALT FS is supplied in rolls making it easy to transport and lift into position. The fabric can be simply cut with scissors and its flexible properties means it is easily shaped around structural and service penetrations to create an effective smoke seal. Complete DIY instructions are available.

SMOKEHALT FS provides up to 2 hours integrity only fire resistance level and good radiation shielding properties.

Smoke Control also supplies a full range of flexible and rigid integrity only, partially insulated and fully insulated fire and smoke barriers including ORBIT FR, FLAMESEAL 60/30 and FLAMESEAL PLUS. Please contact us for details.

## KEY FEATURES

- Flexible fabric smoke barrier.
- Contains no respirable fibres
- 2 hours fire rating (-/120/-)
- Practical & Economical.
- Lightweight, slimline
- Designed for limited space installations.
- Installation using standard tools.
- Complete DIY instructions available.
- Ideal for class 9a & 9c buildings.

**SmokeHalt FS**

# FIRE & SMOKE CONTAINMENT CAVITY BARRIERS

(IDEAL FOR CREATING SMOKE RESERVOIRS IN WAREHOUSES)



## Description

SMOKEHALT FS is pale green in colour. It is user friendly, flexible, durable and easy to manipulate and cut to shape using household scissors.

## Installation

Complete Do-It-Yourself (DIY) installation instructions are available. Alternatively, Smoke Control can provide customers with supply and installation through our fully trained and approved installer network Australia wide.

## Maintenance

Annual maintenance and inspection of the system should be conducted by trained personnel in strict accordance with our documents procedures.

## Sizes

SMOKEHALT FS is supplied in rolls of: 1200mm wide x 25m long.

## Project Specification

Extend all smoke walls to the under side of the roof with SMOKEHALT FS by Smoke Control or approved equivalent. The system shall provide a fire resistance level of -/120/- when tested in accordance with AS1530.4

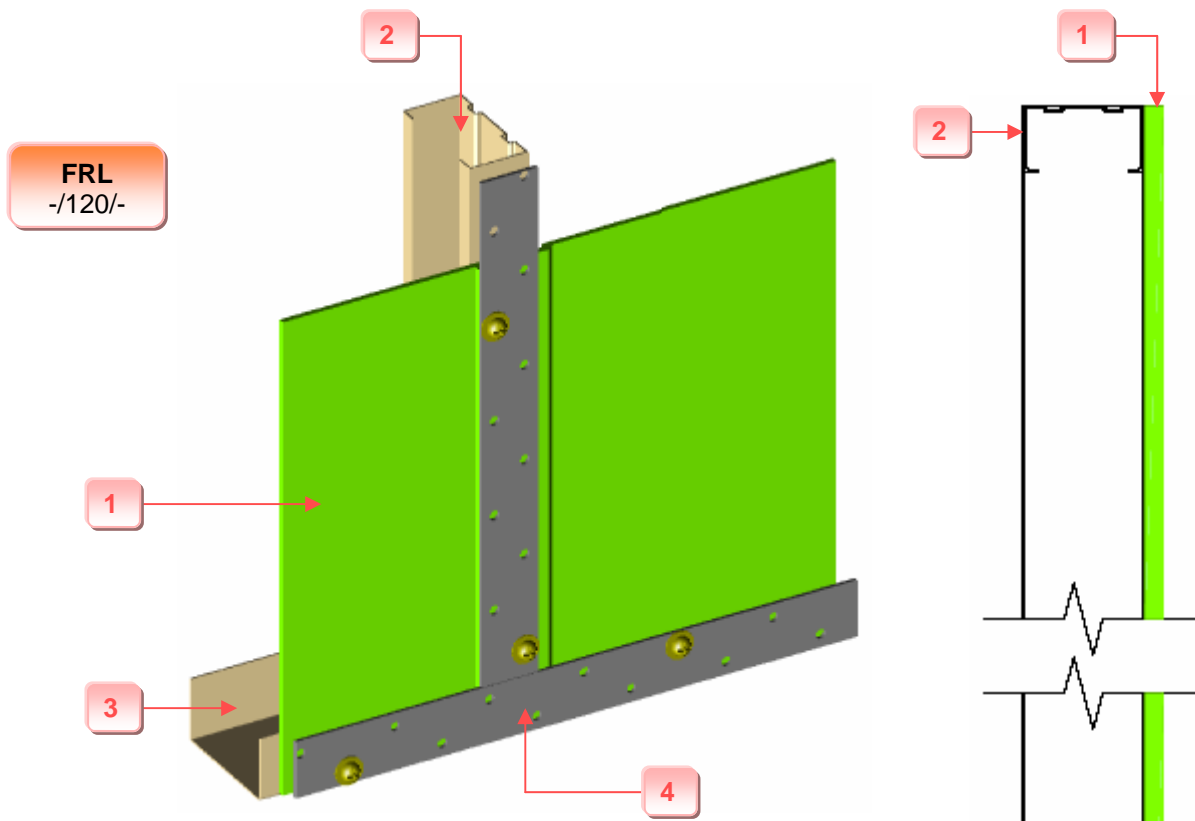

*Figure 1.1: Typical SMOKEHALT FS Installation*

Information given in this publication is given to the best of our knowledge and in good faith. Smoke Control is not responsible if recipients of test reports, assessments or literature misinterpret the contents and wrongly use products based on those misinterpretations. No liability is accepted for error omissions in this document. Smoke Control reserves the right to change specification without notice.

FLAMMABLE SEAL FS

## Roof Cavity Barriers Systems (fixed to one side only)



- Key:**
- 1 FLAMESEAL FS
  - 2 Steel stud
  - 3 Steel track
  - 4 Punched strapping

**FLAMESEAL FS**

<b>FLAMESEAL FS</b>	Fix to one side only
<b>Stud work</b>	64mm studs and top and bottom channel
<b>Vertical stud spacing</b>	Nominal 950mm centres (maximum) or 800mm centres with any service penetration.
<b>Fixings</b>	Using punched strapping (Carlray or equivalent) with self tapping screws @ 200mm centres.

\* For more detailed installation details, contact Smoke Control.